

Product Descriptions

The luminaire contains a constant-current driver and LED light sources. It will operate when supplied with power that meets the specifications on the product's nameplate.

Technical Parameter

LED Roadway Light				
Model	T78S03	T78S06	T78M10	T78L15
Power	30W	60W	100W	150W
Supply Current	0.14A	0.29A	0.48A	0.72A
Operating Volatage	<input type="checkbox"/> 100~240V <input type="checkbox"/> 100~277V <input type="checkbox"/> 200~240V <input type="checkbox"/> 220~240V <input type="checkbox"/> 200~277V <input type="checkbox"/> Others ____			
Rated Volatge	220V 50Hz			
Power Factor	0.95			
Operating Environment	-40℃~+50℃, 10%~90% RH			
Storage Environment	-40℃~+50℃, 10%~90% RH			
Bolt Torque	17Nm			
Recommended Mounting Height	6~15m			
Recommended Mounting Spacing	20~45m			
Dimensions ^①	508×194×96mm	543×235×96mm	594×235×96mm	696×235×96mm
Project Area ^①	0.106m ²	0.139m ²	0.151m ²	0.175m ²
Dimensions ^②	413×184×192mm	448×235×192mm	499×235×192mm	601×235×192mm
Project Area ^②	0.098m ²	0.131m ²	0.143m ²	0.167m ²
Net Weight	3.4kg	3.9kg	4.5kg	5.2kg
IP Rating	<input type="checkbox"/> IP54 <input type="checkbox"/> IP65 <input type="checkbox"/> IP66 <input type="checkbox"/> Other ____			

Note: The net weight of the above product is a typical value. Power represents the maximum rated capacity of this module, with a 10% measurement deviation.

① Dimensions for horizontal adapter installation. ② Dimensions for vertical adapter installation.

Applications

This luminaire is primarily designed for road lighting in arterial roads, secondary roads, branch roads, factories, schools, gardens, various residential communities, and courtyards.

Installation & Maintenance

Installation Procedure

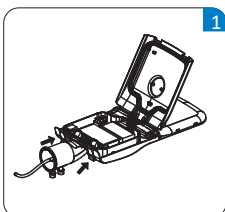

1. Open the luminaire: Release the buckles on the main body and lift the top cover.

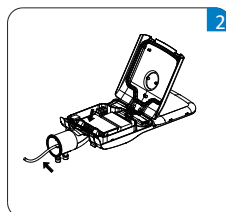

2. Route the cable: Loosen the PG waterproof connector. Feed the mains cable through the light pole and the PG connector into the electrical compartment.

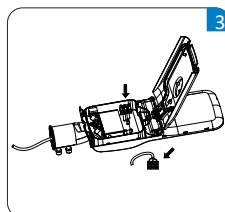

3. Connect the wires: Connect the mains cable to the terminal block as indicated. Adjust the cable length and tighten the PG connector nut.

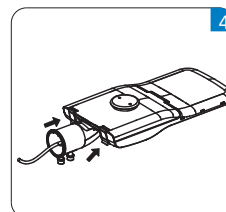

4. Close the cover: Arrange the internal wires, then close the top cover and fasten the buckles.

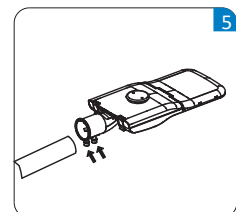

5. Installation complete: Insert the luminaire onto the pole and tighten the two fixing screws to secure it.

Angle Adjustment Diagram

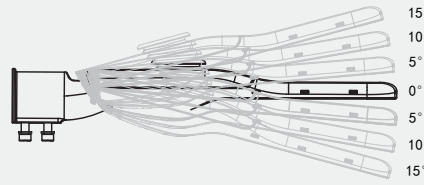
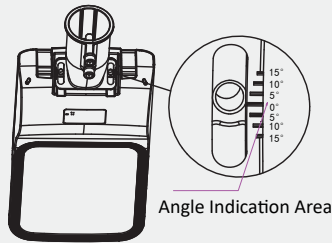

Horizontal Adapter

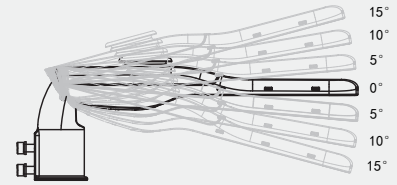

Vertical Adapter

Installation of NEMA Receptacle and Photocell

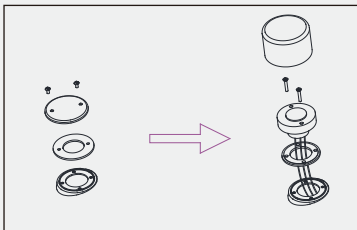

1. Open the luminaire: Release the buckles on the main body and lift the top cover.
2. Mount the base: Pass the photocell base wires through the black sealing ring and into the electrical compartment. Align the screw holes of the base, the sealing ring, and the luminaire housing. Secure the base to the housing with the two M4x25 cross-recessed countersunk head screws.
3. Connect the controller: Screw the photocell controller onto the base. Properly connect the wiring inside the electrical compartment as instructed.

Wiring Instructions

1. If the power input wires are blue, brown, and yellow-green, connect the blue wire to neutral, the brown wire to live, and the yellow-green wire to ground.
2. If the power input wires are white, black, and green, connect the white wire to neutral, the black wire to live, and the green wire to ground.
3. When connecting the power supply, the user must use a junction box with an IP rating no less than the IP rating of the luminaire itself, and the junction box must have a device to fix the conductors.

Cautions

1. Installation and wiring of the luminaire must be carried out with the power disconnected.
2. Power wire connectors must be insulated and waterproof.
3. The glass of this luminaire is designed to break into small pieces. The operating ambient temperature range is -40°C to +160°C. The maximum temperature rise of the glass is $\Delta t160^{\circ}\text{C}$.
4. The light source of this luminaire is not replaceable. When the light source reaches the end of its life, the entire luminaire should be replaced.

Warning: Danger! Risk of Electric Shock!



Safety Precautions

1. The power connection of this luminaire is a non-detachable flexible cable and wire (60245 IEC57). The factory provides a sufficient length of cable based on customer requirements, allowing it to be routed to the ground for connection to the power supply. Be sure to maintain the ingress protection of the connection point and eliminate any tension on the cable where it connects.
2. This luminaire uses type Y connection: If the external flexible cable or wire of this luminaire is damaged, it must be replaced by the manufacturer, its service agent, or a similarly qualified person to avoid a hazard.
3. The luminaire can be installed on a normal flammable material surface.

The data in the product specifications on this page may be subject to change.
Please contact your dedicated account manager for the latest product details.

Aug. 2025

HPA4044TK3.LS01