

# Installation Instructions

## Descriptions

The luminaire contains constant-current driver(s) and LED module(s). It works under technical conditions as the product labels indicate. Its modular design makes it convenient to replace whichever of the modules that failed.

## Technical Parameter

LED Street Light					
Module Quantity	1	2	3	4	5
Power	60W	120W	180W	240W	300W
Input Voltage	<input type="checkbox"/> 100~240V <input type="checkbox"/> 100~277V <input type="checkbox"/> 220~240V <input type="checkbox"/> 120~277V <input type="checkbox"/> 277~480V <input type="checkbox"/> Other____				Frequency 50/60Hz
Power Factor	0.95				
Working Environment	-40°C~+50°C, 10%~90%RH				
Bolt Torque	17Nm				
Mounting Height	6~15m				
Mounting Spacing	20~45m				
Dimensions	670x325x180mm	670x325x180mm	750x325x180mm	830x325x180mm	910x325x180mm
Net Weight	8.0kg	8.7kg	9.9kg	11.5kg	13.0kg
Project Area	0.218m <sup>2</sup>	0.218m <sup>2</sup>	0.244m <sup>2</sup>	0.270m <sup>2</sup>	0.296m <sup>2</sup>
Degree of Protection	<input type="checkbox"/> IP54 <input type="checkbox"/> IP65 <input type="checkbox"/> IP66 <input type="checkbox"/> IP67 <input type="checkbox"/> Other____				

Notes: The above net weight is typical value. The power above are maximum rated power of the model subject to tolerance of 10%.

## Applications

Expressway, highway, avenue, trunk road, sub-trunk road, path, parking lot, factory, schoolyard, garden, park, residential area, courtyard, etc.

## Installation and Maintenance

### Installation

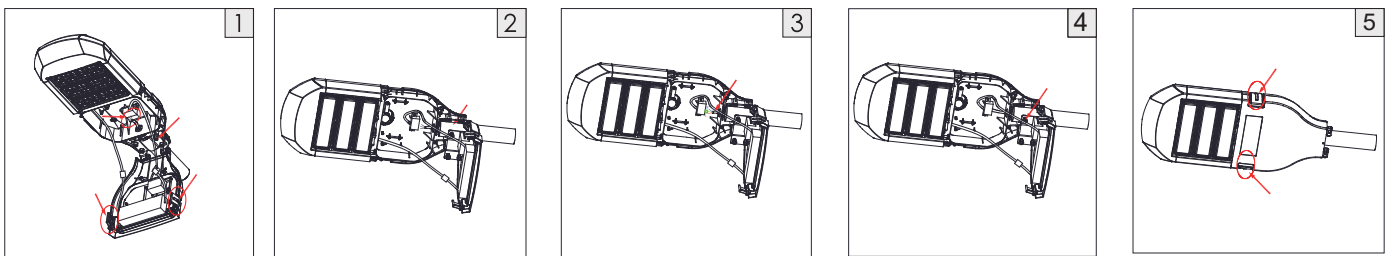

1. Open 2 latches, loosen 4 screws on the mounting bracket, and insert the wire from the pole through the gland nut.
2. Mount the luminaire onto the pole arm.
3. Connect the wires to AC input. Make sure it sufficiently grounded.
4. Adjust the lamp to required mounting position, fasten 4 screws on the mounting bracket with wrench.
5. Put inside wires in order, close the driver box cover and fasten it with 2 latches. Installation finished.

### Module Maintenance

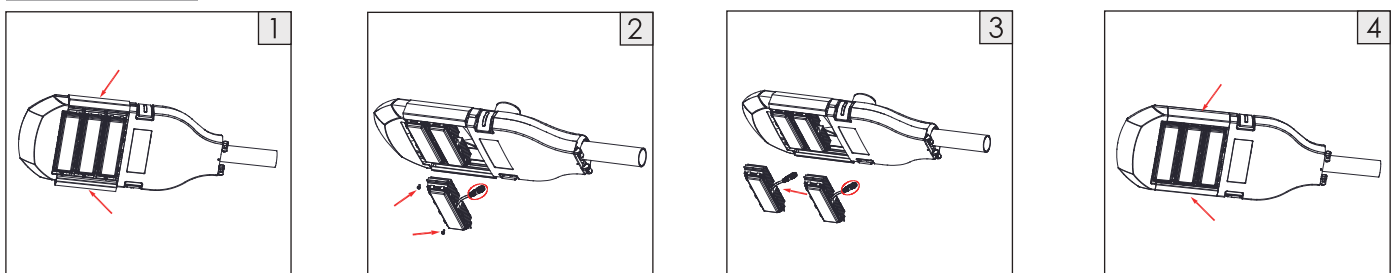

1. Open the side beams outward with hands.
2. Loosen the screws on both sides of module and disconnect the waterproof connectors.
3. Replace with qualified module(s), fasten the screws on both sides of module and connect the waterproof connectors.
4. Close the side beams inward with hands.

# Installation Instructions

## Installation of NEMA Receptacle and Photocell

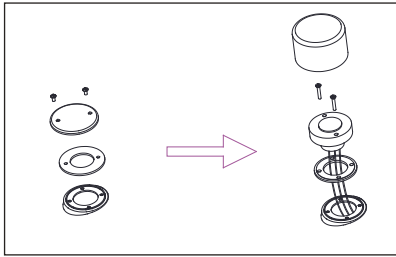

1. Undo the two screws to remove the round cover and its white sealing washer.
2. Thread the wires of the receptacle through the black sealing washer into the electrical compartment of luminaire. Keep the screw holes in alignment among the receptacle, sealing ring and luminaire, and fixate the receptacle with two M4x25 cross recessed countersunk head screws.
3. Plug in and fasten the photocell. Connect the wires in the electrical compartment.

## Cable Connectors

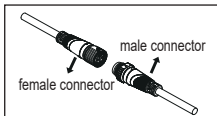

1. Connect the male and female connectors by aligning the indicative arrow on them.

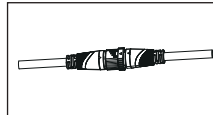

2. Hold the nut on one terminal still, meanwhile, rotating clockwise till the one on the other terminals is tightened up. Otherwise the waterproof performance might be affected.

## Wiring

Power Supply End	Earth wire	Neutral wire	Live wire
Fixture End	Yellow-green lead	Blue lead	Brown lead
	Green lead	White lead	Black lead

## Caution

- a** Disconnect or turn off power before installation, maintenance and wiring.
- b** Cable connection must be insulated and waterproof.
- c** For luminaires with glass cover: the cover is made of tempered glass which shatters into small pieces without sharp edges when it breaks. Application condition: -30°C~100°C; maximum temperature rise  $\Delta t 60^{\circ}\text{C}$ .
- d** The light source of this luminaire is not replaceable. When the light source's lifetime comes to an end, it is the whole luminaire that should be replaced.

Warning: Danger! Electric shock risk!

(via IEC 60417-6042 (2011-11) )



For luminaires with glass cover: The broken cover should be replaced.

Rectangle

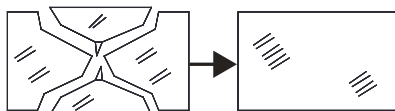

Round

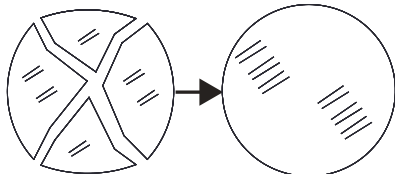

The luminaire shall be installed by a qualified electrician and wired in accordance with the latest IEE electrical regulations or the national requirements.



This marking indicates that this product should not be disposed with other household wastes throughout the EU. To prevent possible harm to the environment or human health from uncontrolled waste disposal, recycle it responsibly to promote the sustainable reuse of material resources. To return your used device, please use the return and collection systems or contact the retailer where the product was purchased. They can take this product for environmental safe recycling

## Remarks

1. This luminaire uses permanent connection on power supply with flexible cable and wires (60245 IEC57). Sufficient length of cable is reserved for connection to AC power. Protection over the connection joint and elimination of tensile force there should be ensured.
2. This luminaire uses type Y attachment: method of attachment of the cable or cord such that any replacement can only be made by the manufacturer, his service agent or similarly qualified person.
3. Wiring: the connection to AC power should be operated on terminal blocks in a wiring box with a degree of protection at least equivalent to the luminaire, and there should be devices to fixate wires.
4. The luminaire can be mounted onto ordinary combustible surfaces.