

# FL21B

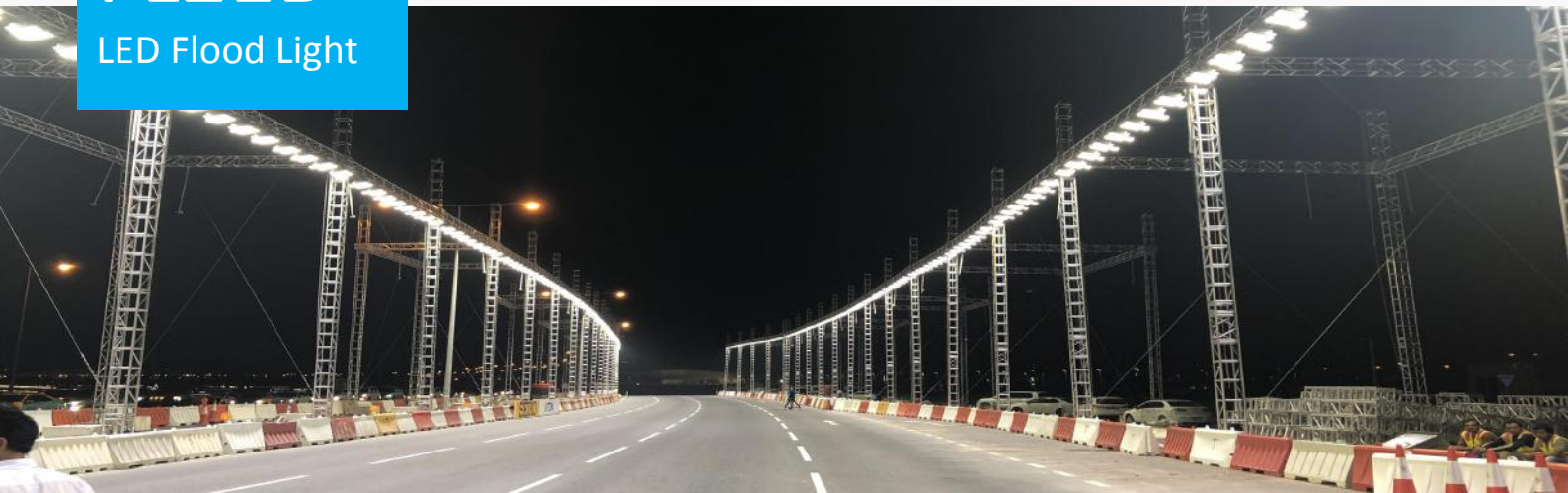

## LED Flood Light



### Specifications

<b>Input Voltage:</b>	100 ~ 277Vac
<b>Input Frequency:</b>	50 / 60Hz
<b>Power Factor:</b>	0.95
<b>Surge Protection Level:</b>	10kV line-earth
<b>Working Environment:</b>	-40°C ~ +50°C, 10% ~ 90% RH
<b>CCT:</b>	3000K, 4000K, 5000K, 5700K
<b>CRI:</b>	≥70
<b>Housing:</b>	Die-cast Aluminum
<b>IP Rating of LED Engine:</b>	IP68
<b>IP Rating of LED Driver:</b>	IP67
<b>Warranty:</b>	5 Years Limited

### Finishing Colors

	Gray		Black
	White		Blue

### Applications

- Sports facilities (stadium, football field, golf course....)
- Traffic arteries (airport, crossroad....)
- Advertisement (wall, billboard....)

### Features

#### Construction

- Die-cast aluminum housing.
- Unique patented IP68 LED light engines.
- Whole structure heating dissipation design with best thermal conduction and radiation.
- Tempered glass cover available as optional choice.
- IP67 rated luminaire. IP66 with the glass cover.

#### Distribution

- Ergonomic and dedicated lighting distributions.

#### Mounting

- Bracket adjustable within  $\pm 60^\circ$ .

### Photos



# FL21B

LED Flood Light

## Ordering Information

Example: FL21B-N1-30-BA-24-2260-7040-LU-MO-BK

Luminaire Type	Module Qty.	System Power	LED Package	Cable Standard	LED Qty per Module	
<b>FL</b> Flood light	<b>N1</b> 1 engines	<b>30</b> 30W <b>40</b> 40W <b>50</b> 50W <b>60</b> 60w	<b>C</b> 3030	<b>A</b> CCC+VDE <b>C</b> PSE <b>H</b> UL <b>X</b> Others	<b>63</b> 63pcs	
<b>21B</b> 21B series			<b>B</b> 5050		<b>24</b> 24pcs	
Lens Code		CRI & CCT		Brand of LEDs	Driver Brand	Housing Color
<b>1425</b> 25 degree	<b>1360</b> 60 degree	<b>7030</b> Ra≥70, CCT 3000K	<b>LU</b> LUMILEDS	<b>SS</b> SOSEN	<b>BK</b> Black	
<b>2540</b> 40 degree	<b>1590</b> 90 degree	<b>7040</b> Ra≥70, CCT 4000K	<b>XX</b> OTHER	<b>IN</b> INVENTRONICS	<b>WH</b> White	
<b>2225</b> 25 degree	<b>2260</b> 60 degree	<b>7050</b> Ra≥70, CCT 5000K		<b>MO</b> MOSO	<b>BU</b> Blue	
<b>1240</b> 40 degree	<b>2290</b> 90 degree	<b>7057</b> Ra≥70, CCT 5700K		<b>XX</b> OTHER	<b>GY</b> Gray	

## Performance

Model	Power (W)	3030 LEDs		5050 LEDs	
		Efficacy (lm/W)	Flux (lm)	Efficacy (lm/W)	Flux (lm)
FL21B-N1	30	135	4050	167	5010
	40	130	5200	163	6520
	50	125	6250	157	7850
	60	117	7020	150	9000

Notes 1: Above values are calculated based on the product with CRI≥7 and CCT over 3000K, values of CCT 3000K are 5% lower than above values.

Notes 2: Values shown are subject to ±5%~±8% tolerance.

Notes 3: With optional tempered glass cover, efficacy drops by around 8%.

## Dimensions

Model	L (mm)	W (mm)	H (mm)	N.W.* (kg)
FL21B	260	230	220	2.8

Notes: Typical values above, tolerance: dimensions ±5mm; N.W. ±5%

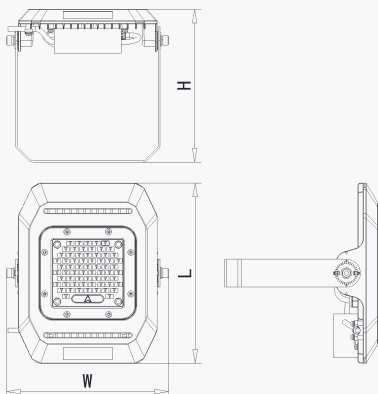

## Package Information

Model	L (mm)	W (mm)	H (mm)	G.W.* (kg)
FL21B	345	280	140	3.3

Notes: Typical values above, tolerance: dimensions ±5mm; G.W. ±5%

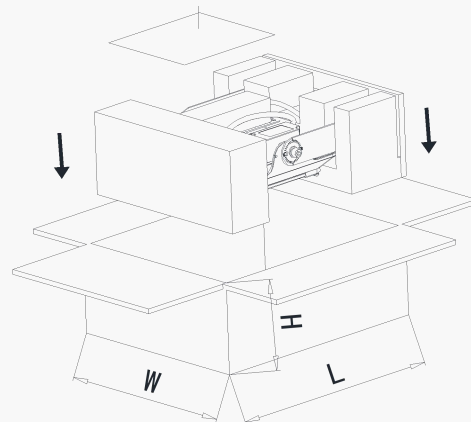

# FL21B

LED Flood Light

## Installation Bracket

Model	Mounting Holes
-------	----------------

FL21B

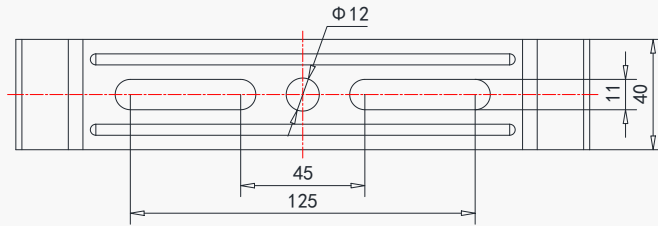

## Accessories

FL21B Tempered Glass Cover
----------------------------



## Distributions

3030 Solution

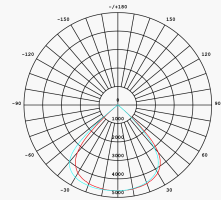
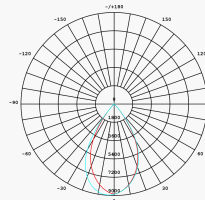
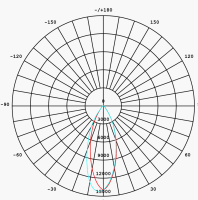
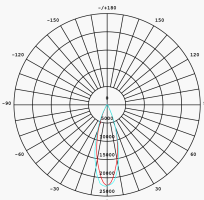

25D1425	40D2540	60D1360	90D1590
---------	---------	---------	---------

5050 Solution

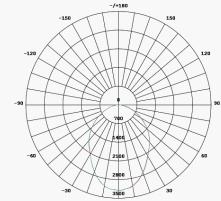
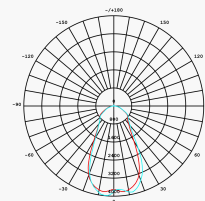
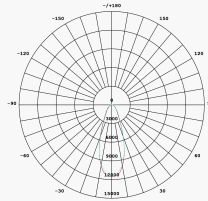
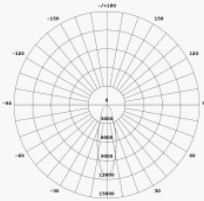

25D2225	40D1240	60D2260	90D2290
---------	---------	---------	---------

## Version History

Change Date	Version	Item	Description of Change	
			From	To
2020/06/18	Ver1.0	Datasheet Release	/	/